



PUNTI DI CHIUSURA SUPPLEMENTARE



Punti di chiusura supplementare | Extra locking pin
Pivot de fermeture supplementaire | Pernio de cierre suplementario



Perno e vite M5
TSP CR in acciaio
zincato. Art. 4246
eccentrico di chiusura
in zama, regolabile
in pressione in 8
posizioni diverse.



Pin and M5 TSP
CR screw in
galvanized steel.
Art. 4246 locking
cam in zamak, with
adjustable pressure in
8 different positions.



Pivot et vis M5 TSP
CR en acier zingué.
Art. 4246 came de
fermeture en zamak,
réglable en pression
avec 8 positions
différentes.



Pernio y tornillo M5
TSP CR de acero
galvanizado. Art. 4246
excéntrica de cierre
de zamak, regulable
a presión en 8
posiciones diferentes.



ART.	4241 4241.1 4242 4207.1 4207.2 4207.11 4246	4246.10 4246.11
Imballo Package Conditionnement Embalaje	50 Pz	20 Pz
Finiture disponibili Available finishes Finitions disponibles Acabados disponibles	1 2 3 4	1 2 3 4

1 424X

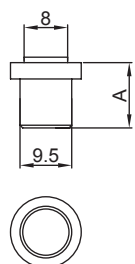

ART.	A
4241	9
4241.1	10.5
4242	12

2 4246

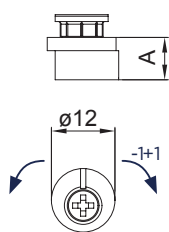

ART.	A
4246	8

3 4246.1

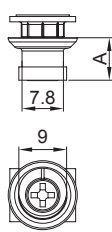

Abbinabile con la
cremonese art. 6010.12
Compatible with
cremone-bolt art. 6010.12

ART.	A
4246	8

4 4248.1

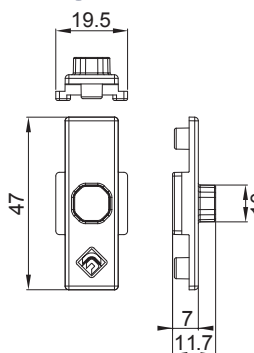

ART.	NODO SECTION
4248.11	A01 - A02 - A03 A05 - A06 B01 - B03

5 4248.1X

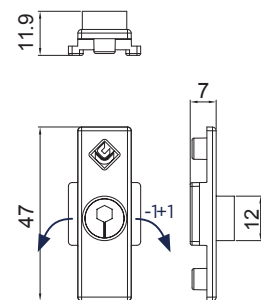

ART.	NODO SECTION
4248.11	A01 - A02 - A03 A05 - A06 B01 - B03
4248.12	A08 - B04

6 4207.2

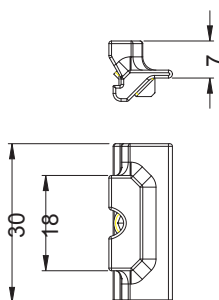

ART.	NODO SECTION
4207.2	A08 - B04

7 4207.1

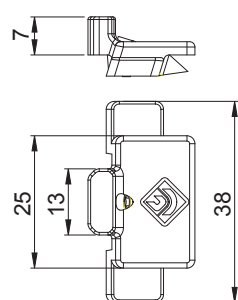

ART.	NODO SECTION
4207.1	A01 - A02 - A03 A05 - A06 B01 - B03

8 4207.4

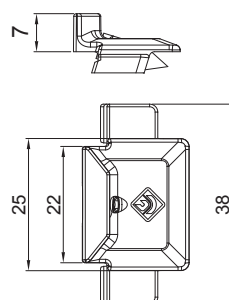

ART.	NODO SECTION
4207.4	A01 - A02 - A03 A05 - A06 - B01 B03

9 4207.11

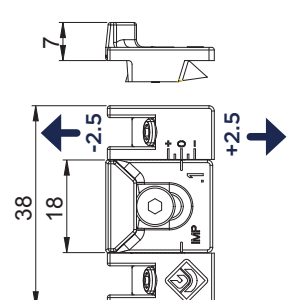

ART.	NODO SECTION
4207.11	A01 - A02 A03 A05 - A06 - B01 B03

6

+

5

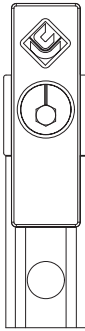

ART.	NODO SECTION
3421.32	A08 - B04

6

+

2

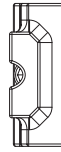

ART.	NODO SECTION
4246.10	A08 - B04

7

+

5

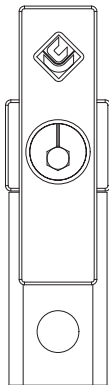
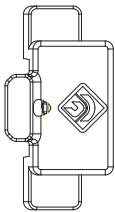

ART.	NODO SECTION
3520.32	A01 - A02 A04 - A05 A06 - B01 B03

7

+

2

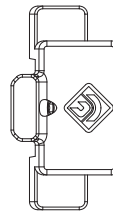

ART.	NODO SECTION
4246.11	A01 - A02 A04 - A05 A06 - B01 B03

8

+

5

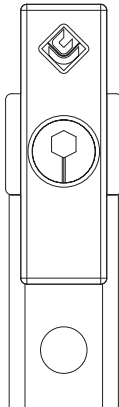
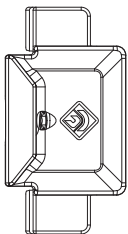

ART.	NODO SECTION
4207.21	A01 - A02 A04 - A05 A06 - B01 B03

9

+

4

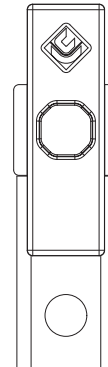
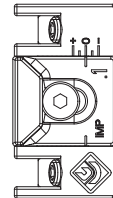

ART.	NODO SECTION
3400F.32	A01 - A02 A04 - A05 A06 - B01 B03