



MANIGLIA DI TRAINO

Maniglia di traino | Pull handle
Poignee de tirage | Manilla tiradora



Maniglia in alluminio estruso; tappi in nylon.



Handle in extruded aluminum; nylon plugs.



Poignée en aluminium extrudé ; bouchons en nylon.



Manilla de aluminio extruido; tapones de nylon.



ART.	6490 6491 6493 6494
Imballo Package Conditionnement Embalaje	20 Pz
Finiture disponibili Available finishes Finitions disponibles Acabados disponibles	1 2 3 4

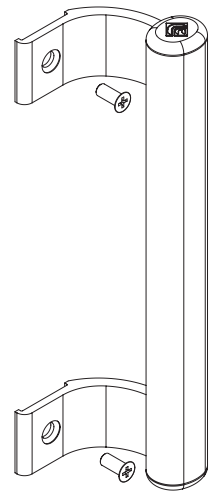
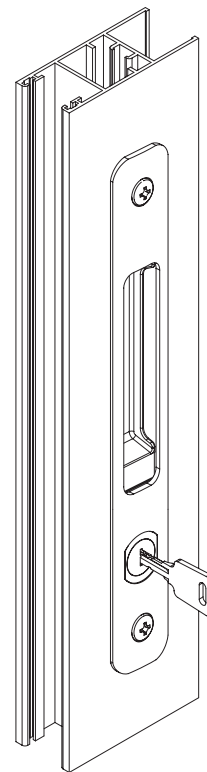
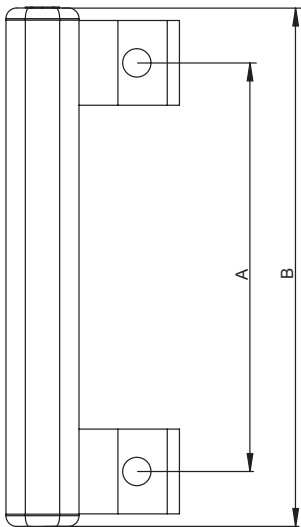
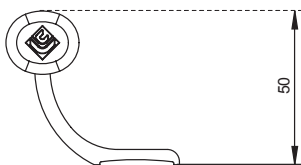

ART.	DESCRIZIONE DESCRIPTION	A	B
6490	Da accoppiare alle maniglie INNER con lavorazione 143x19,5 To combine with the handles INNER with working slot 143x19,5	134	169
6491	Da accoppiare alle maniglie INNER con lavorazione 165x19,5 To combine with the handles INNER with working slot 165x19,5	155	190
6493	Da accoppiare alle maniglie INNER con lavorazione 187x19,5 To combine with the handles INNER with working slot 187x19,5	167	202
6494	Da accoppiare alle maniglie INNER con lavorazione 205x19,5 To combine with the handles INNER with working slot 205x19,5	185	220